



F-1 Premium User's manual



Thank you for purchasing LOOKING's F-1 Premium DVR.

This manual will go through on how to use the On-Board Camera System and provide you with detailed product information regarding operation, precautions, and technical data. Please read this manual carefully.

Disclaimer

The material and information contained in this manual is for general information purposes only.

- To ensure the integrity of the video, please use a genuine high-speed Class 10 memory card and format it regularly.
- The terms and conditions are subject to change at any time without prior notice.

Product Structures

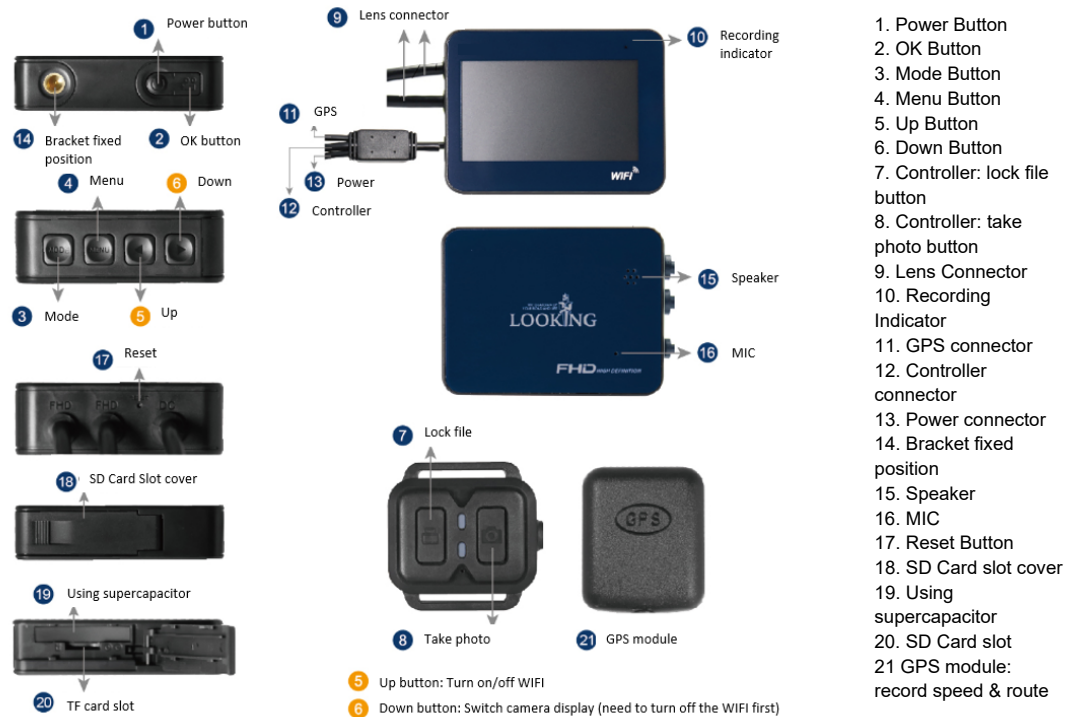

Wired controller



GPS module

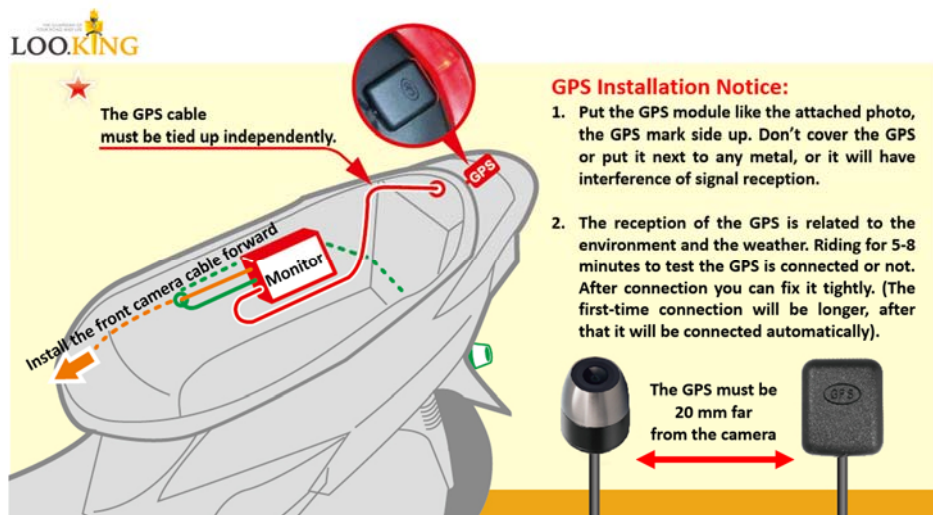

Product Features

1. Dual Channel: SONY IMX323 Sensor FHD 1920x1080
2. Auto white Balance adjustment
3. Lens angle 140 degree
4. 2.7inch TFT display (16:9)
5. Supports max. 128G micro SD card
6. Lean-angle auto lock function.
7. Wired controller to lock the current file and take photo easily.
8. GPS function to record the speed and route, the data can be viewed when playback by using APP.

Key Operation

1. Power button: Press and hold 6 seconds to turn on/off the machine
2. OK button:
 - a. In video mode, press to start/stop recording
 - b. In photo mode, press to take pictures
 - c. In playback mode, press to start/stop playback
 - d. In the menu settings, press to confirm selection or enter selected menu
3. Mode button: With recording paused, short press to switch between video, photo, or playback modes.
4. Menu button: With recording paused, short press to enter the settings menu.
5. Up button:
 - a. Turn on/off WIFI.
 - b. Scrolls through menu items.
6. Down button: Scrolls through menu items

SD card

1. Insert the SD card according the indicated direction
2. To remove the memory card, push the card in and the card should automatically pop out.
 - a. **Important**
 - i. Please format the memory card when using a new card.
 - ii. SD card must be a minimum of 80MB/s (Class: U3)

Power on/off and Auto shut-off

1. Press and hold the power button for 6 seconds to turn on/off the machine.
2. The machine can be programmed to shut down automatically to save power; if the machine is not recording, it will automatically shut off.

Recording mode

1. Recording mode is the default mode for this device. When in recording mode, you will see the  icon in the upper left-hand corner and a flashing ● icon.
2. In recording mode, press the recording button to start/stop recording.
3. Press menu button to enter the video settings menu, up and down buttons can scroll through menu items. Under the video settings menu, you can choose the resolution, segment of recording, audio on/off...etc.
4. Use controller: Press the lock button to save the current recording file; press the camera button to take a photo.

Note:

The machine will be powered automatically when turn the key on, please do not remove the SD card when the machine is recording.

Camera mode

1. Stop recording and enter the camera mode by using the mode button. When in camera mode, you will see the  icon in the upper left-hand corner
2. Press menu button to enter the camera settings menu, up and down buttons can scroll through menu items. Under the camera settings menu, you can choose the resolution, color, contrast...etc.

Playback mode

1. Stop recording and enter the playback mode by using the mode button. When in playback mode, you will see the  icon in the upper left-hand corner
2. Press menu button to enter the playback settings menu, up and down buttons can scroll through menu items. Under the playback settings menu, you can delete or save the recordings.

General Settings

1. Press menu button to enter the settings menu, press twice the menu button to enter the general settings menu.
2. Date/Time: Use the Up and Down buttons to set the correct values and press Ok to confirm.
3. Auto shut-off: The machine can be programmed to shut down automatically to save power.
4. Languages: Multiple languages supported.
5. Key tone: Turn on/off the key tone.
6. Format: Format the micro SD card.
7. Screen saver: Once the machine has started recording, the screen can be set to turn off
8. Version: To view the current software version for the machine.

Troubleshooting

1. Unit not recording: Check the SD card if there is enough space.
2. Stop recording while riding:
 - a. Check the SD card if is Class 10 and with 80MB/S above. The SD card writing & reading speed is required to this device.
 - b. Check the loop recording setting is on or not.
3. "Wrong file" or "damaged file" showed: Check the SD card and format it (please use the device to format the SD card not by PC).
4. Fuzzy image: Check the camera lens and clean it.
5. Buttons not working: Turn off the WIFI first, if the WIFI function is on, the buttons cannot work.

WIFI APP

Please scan the QR code to download the APP, or search VF CAM on Google play / VF CAM+ on APP store.



Android VF cam



iOS VF cam+

1. Scan the QR code to download the app
2. Switch on the motorcycle DVR and WIFI function (the WIFI default setting is on)
3. The WIFI name & password will show on the display. Password: 12345678
4. After the device is linked, you may now use the APP
5. Only when connecting the GPS, you will find the route & speed when playback.

PS. When the device is on, short press ▲ you can turn off the Wi-Fi function, and press the ▲ to turn on the wifi function.

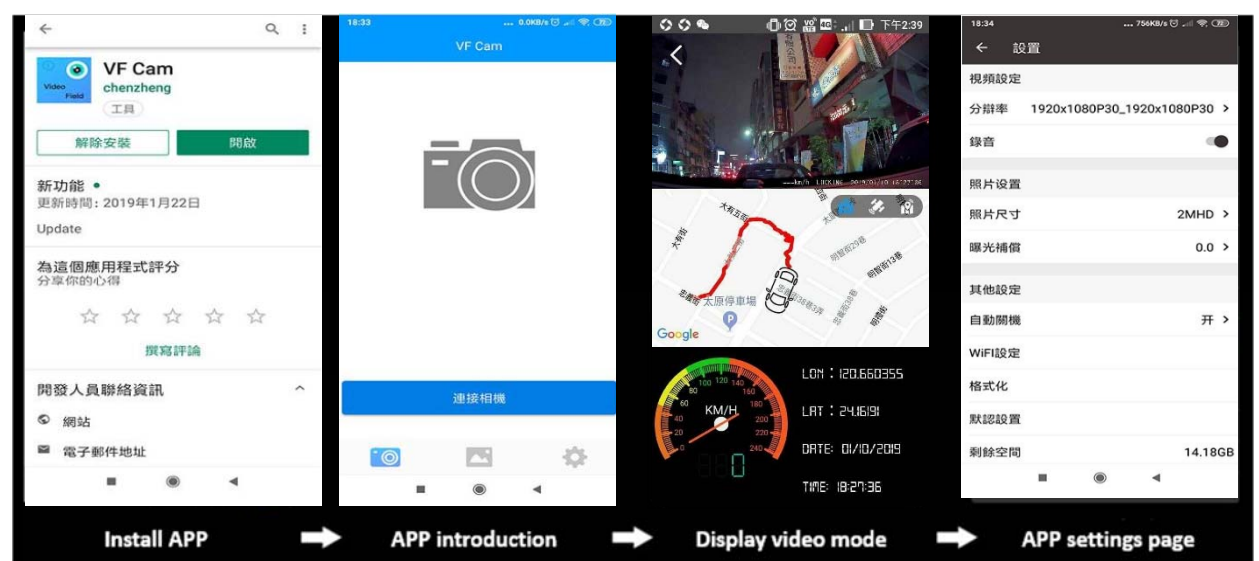

Product Specification

| | |
|---------------------|---|
| Sensor | Dual channel 1920x1080 SONY IMX323 |
| Lens | F1.9 |
| Display | 2.7" LCD TFT 16:9 |
| Resolution | Dual channel FHD1080P 30fps |
| Audio | Build-in MIC/Speaker |
| Memory card | Max. 128G micro SDHC (class 10) |
| White balance | Auto |
| Power supply | Multi-pin connector Input: 12V-24V 2A Output: 5V 2A |
| Battery | Supercapacitor |
| Size | 74 x 55 x 20 mm |
| Working humidity | 10%-80% |
| Working Temperature | -10 °C ~ +65°C |